

TORO[®]

MAX

INDUSTRIAL LABEL PRINTER



**QUICK START
GUIDE**

READ ME FIRST

DuraLabel[®]

**800-788-5572
DuraLabel.com**

SAFETY INSTRUCTIONS

Please review the following safety instructions before using the printer:

- Keep Toro Max away from extreme humidity (>85%) and prolonged exposure to direct sunlight.
- Use only with power supply model WDS5150240 (included with the system).
- To completely disconnect power from your Toro Max, remove the battery and unplug the power supply from its wall socket.
- Do not pour liquids onto the printer or its parts. For ordinary cleaning, follow the instructions included in this guide.
- Only qualified service personnel should attempt to repair the printer.
- Toro Max supply may build a small static charge during loading or use. Do not operate Toro Max near flammable materials.
- Do not attempt to use a Toro (original) battery in your Toro Max; a battery specifically made for the Toro Max is available as an optional accessory. Please contact your DuraLabel representative for more information.

 **NOTE:** Changes or modifications not expressly approved by the party responsible for compliance could void the user's authority to operate the equipment.

If you have any issues, please contact DuraLabel support by calling **800-788-5572** or visiting ***DuraLabel.com***.



GETTING STARTED

Thank you for choosing the DuraLabel Toro Max. With this standalone system, producing custom labels and signs is fast and easy. This guide will show you how to set up your new Toro Max, load supplies, and start printing labels.

In the Box



**Toro Max battery (sold separately) shipped in separate box.*

Initial Setup

1. Place Toro Max printer on a secure, flat surface, with the Control Panel facing you.
2. Plug the AC Adapter into a standard, grounded three-prong wall outlet. Then, plug the other end of the power cord into your Toro Max power socket, ensuring the **flat side of the connector is facing up**. This connector uses a slider to latch into place, preventing accidental disconnects. To unplug the connector from your Toro Max, grasp the plug slider and pull it away from the printer.

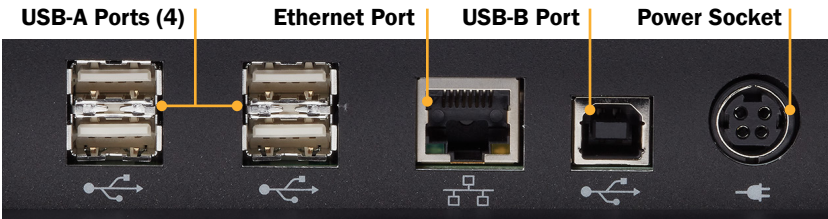

3. Slide the Keyboard Release Slider (on the Control Panel) to the right, and swing the keyboard down.

GETTING STARTED

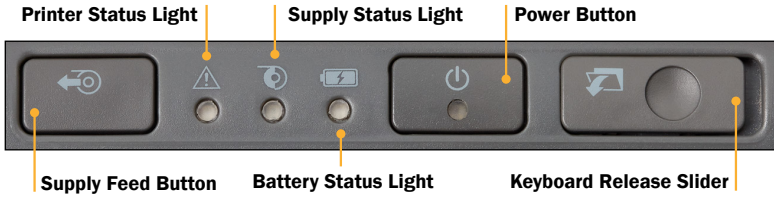

4. To adjust the screen angle, push the Touch Screen Release Button (to the right of the screen). The screen will pop forward, and you can lift the screen to the desired angle.
5. Press the Power button (on the Control Panel) to turn on your Toro Max. Once the system powers up, use a finger or included stylus to navigate with the touchscreen.
6. (Optional) If you prefer, you can use the included wireless mouse instead of the touchscreen controls. Connect the mouse's small USB receiver (stowed in the mouse's battery compartment) to one of the USB-A ports on your Toro Max. Then, slide the mouse's power switch to ON. The wireless mouse uses one AA battery.

Installing the Battery

To use your Toro Max without an AC power supply connected, you will need the Toro Max battery installed and charged. When fully charged, the battery will allow for up to 3 hours of use in the field.

To install the battery:

1. Remove the battery cover from the back of your Toro Max by pushing the slider downward and pulling the door away.
2. Position the battery so the cut-outs are aligned and the contacts on the battery match up with the contacts in the Toro Max.
3. Press the battery in until it locks into place.
4. Return the battery cover to its position, and press it into place.



The Toro Max battery will charge automatically while your Toro Max is plugged in with its AC adapter, whether the system is powered on or off. Charging will stop automatically when the battery is full.



IMPORTANT: If you have a battery for the original DuraLabel Toro system, do not use it in the Toro Max, as the older battery was designed to use a separate charging system. Contact your DuraLabel representative for more information.

LOADING SUPPLIES

Learn how to load your Toro Max with printing ribbon (“ink”) and label stock.

1. Lift the cover release latch and raise the cover of the printer; the ribbon rails will raise automatically. Make sure the cover and rails are fully raised before continuing.



2. Slide the ribbon cartridge into the slot in the rails. The cartridge will only fit the correct way, and a magnet will hold it in place. To remove a ribbon cartridge, simply pull it out.



3. Slide the movable gray guides apart (A). For more room, flip the cutter module down (B) by pulling the top edge away from the body of the printer.

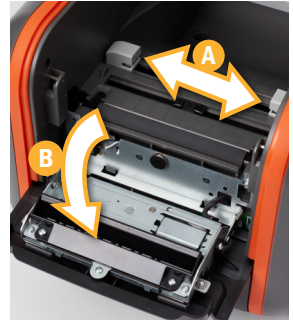

4. Place the roll of label stock onto the supply spindle*. Rest the supply in the supply well, with the spindle fitting into its slots. Feed label stock toward the cutter module, with the printable surface facing upward.



5. Feed the end of the label stock forward to reach over the roller (A). Slide the movable gray guides together so they hold the label stock neatly centered in the printer (B), without bending or wrinkling the label stock.

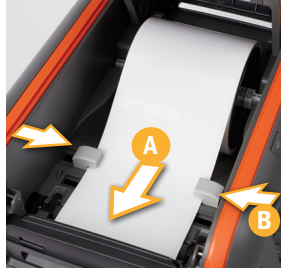

**For narrow supplies, center label stock on the spindle by sliding the fixing tab onto each side.*

6. Lift the cutter module (A), back into its ready position; it will snap into place. Finally, lower the cover until it latches closed (B); the ribbon rails will lower into place automatically. Press firmly on both sides of lid to ensure it's properly closed.



Your Toro Max will recognize the supplies you have loaded and automatically adjust its print settings for the best quality. Now you're ready to design and print custom labels!

CLEANING YOUR TORO MAX

Periodic cleaning of the print head, cutter blade, movable guides, and black rubber roller will extend the life of the printer and help maintain optimal printing quality.



IMPORTANT! Always turn the power off and disconnect Toro Max from all power sources (including the battery, if present) before cleaning or performing maintenance. After cleaning, wait at least 5 seconds before turning the power on again.

TO CLEAN YOUR TORO MAX:

1. Press cover release latch and raise the cover.
2. Remove ribbon cartridge and label stock (if loaded), and place on a clean, flat surface.
3. Gently rub a cleaning swab or soft cloth with isopropyl alcohol back and forth across the front and underside of the print head to remove any built-up adhesive or residue (A).
4. Run the swab or cloth between and around gray adjustable label guides to clear any dust or adhesive build-up (B).
5. Lift two black latches on either side of the platen roller (C), and lift out (D)*. Use the swab or cloth with isopropyl alcohol to gently wipe away any material that has stuck to the roller surface. Insert the platen roller back into printer, then press firmly down on the two black latches until they lock/snap into place.
6. Finally, to clean the cutter blade, gently insert the swab or cloth into the slot of the cutter module and wipe side to side (E). Repeat this process for front and back of the blade (F). Cutter module can be flipped forward to make the back easier to reach.

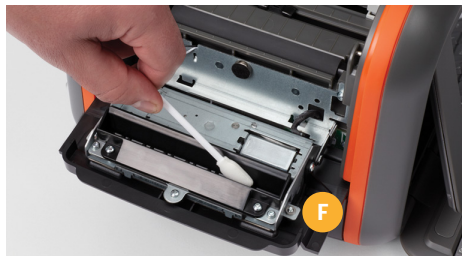
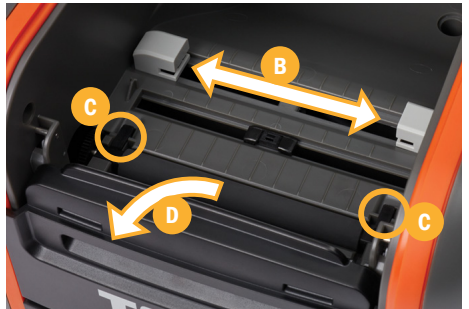

NETWORK SETUP

Toro Max can be connected to a local network, either wired (Ethernet) or wireless. This will allow the printer to communicate over the network, and to receive print jobs from PCs on the network through the PC version of LabelForge PRO. See LabelForge PRO User Guide for additional information. Toro Max's network settings can be easily managed with the on-screen controls. To set up a network connection:

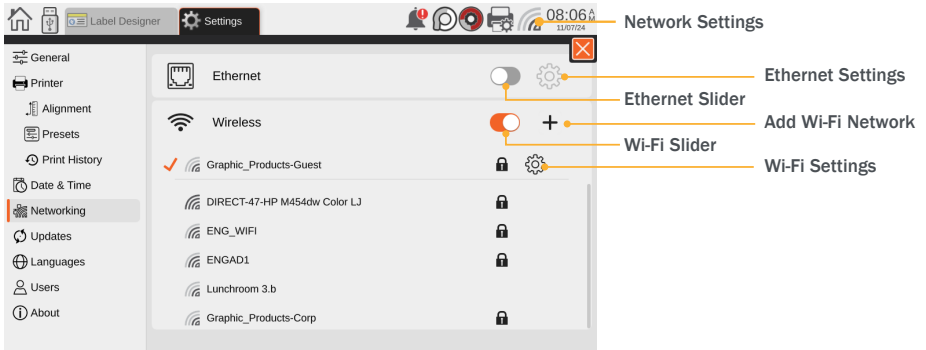

1. Open the **network controls** by clicking on the wireless signal icon in the toolbar, or navigate to the Settings menu from the main screen and choose Networking.
2. To use a **wired Ethernet connection**, simply connect your Toro Max to the network with an Ethernet cable, and make sure the Ethernet option is switched on (with the slider showing orange).
3. To use a **wireless connection**, make sure the Wireless option is switched on (with the slider showing orange). A list of available wireless networks will appear. If your Toro Max is already connected to a wireless network, there will be a checkmark next to the entry for that network.
4. Select your preferred wireless network. If the network is protected by a password, you will be prompted to enter it; then, **click “Connect.”**

To remove saved details about a network, click the gear icon for that network's entry in the list, and choose “Forget Network.”



Graphic Products®, DuraLabel®, PathFinder®, Toro Max®, Bronco Max®, and Kodiak Max® are Registered Trademarks of Graphic Products, Inc. © 2025 Graphic Products, Inc.

To download the full Toro Max User Guide,
visit DuraLabel.info/tm-guide



800-788-5572
DuraLabel.com