

DuraLabel TORO[®] MAX

QUICK START MANUAL



DuraLabel[®]

Thank you for choosing DuraLabel[®] Toro[®] Max Industrial Sign & Label System. With this standalone system, producing custom labels and signs is fast and easy. This manual shows you how to set up your new Toro Max, load supplies, and start printing.

HASSLE-FREE REMOTE SETUP

Connect with a live technical support representative to get help setting up your new printer. Reach out to set up an appointment.

DuraLabel.com/support/remote-printer-setup

REGISTER YOUR PRINTER

Get access to free support, software updates, and special offers.

DuraLabel.com/register

UNBOXING

Verify all items are present.

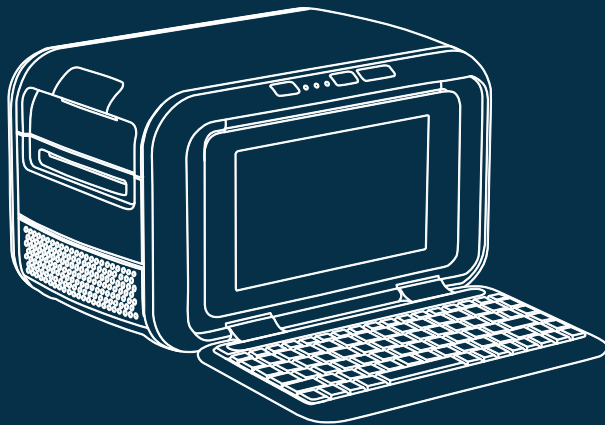

TORO MAX PRINTER



USB DRIVE



MOUSE



LABEL SCRAPER

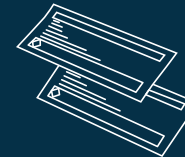

CLEANING SWABS

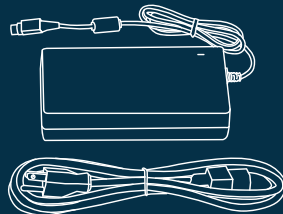

POWER CORD



FIXED TABS

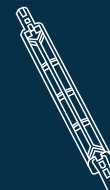

SUPPLY SPINDLE



STYLUS

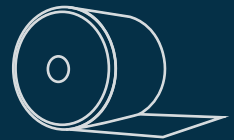

LABEL STOCK



INK RIBBON



BATTERY

ITEMS SOLD SEPARATELY

SETUP Get your printer ready to go.

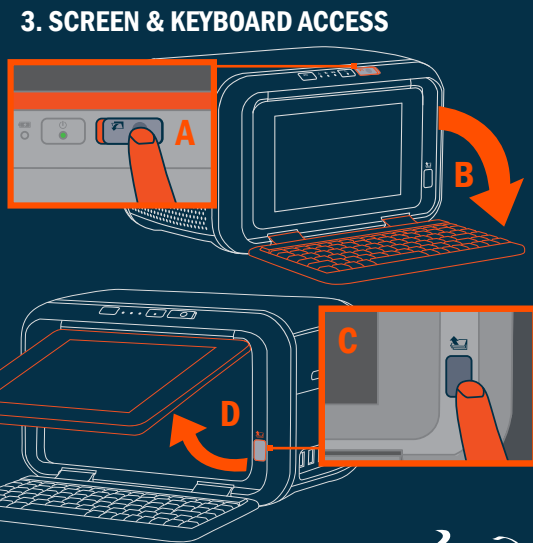
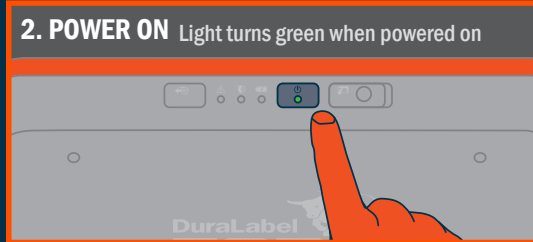
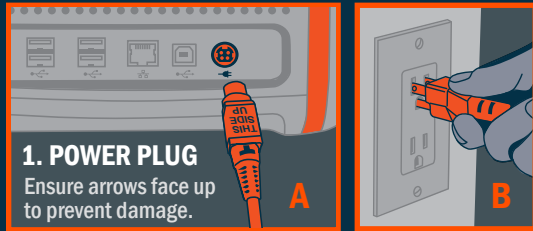

Scan for User Manuals



877-534-5157 | DuraLabel.com

SUPPLY LOADING

RIBBON CARTRIDGE

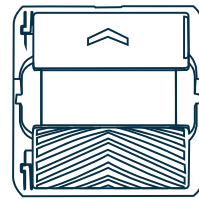

1. Grab cartridge

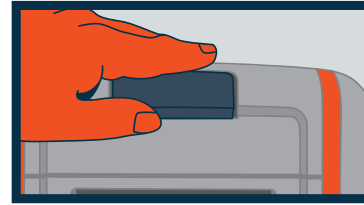

2. Lift cover release latch

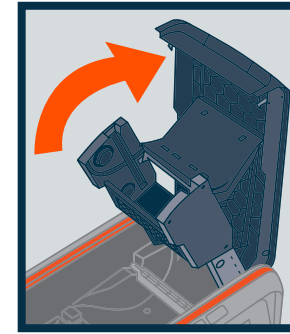

3. Raise cover



4. Slide ribbon cartridge in

LABEL STOCK

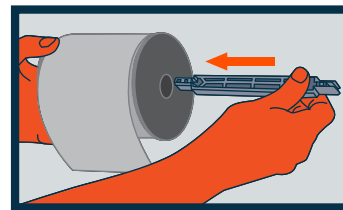

1. Place label stock roll on spindle

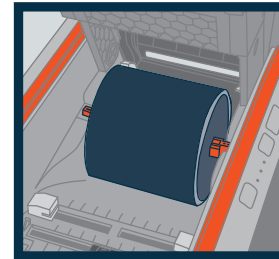

2. Insert roll in place

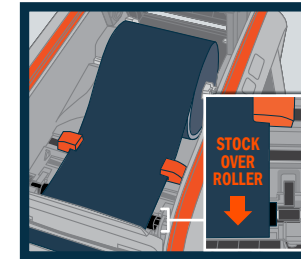

3. Adjust guides, feed label



4. Close lid until it latches; ready!

Create and Print Labels Time to make your first label

PRINT FROM PREMADE SIGNS

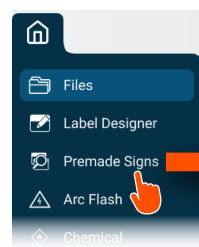

1. Open Premade Signs

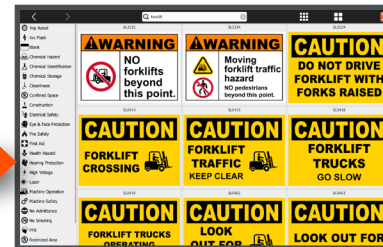

2. Search for and click on a sign

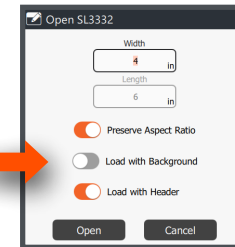

3. Select size & open

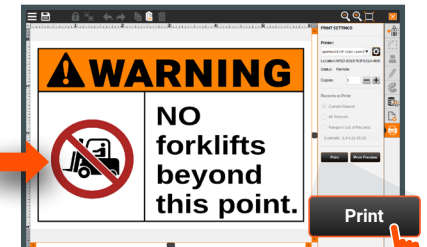

4. Select the printer icon & click print

CREATE LABEL & PRINT

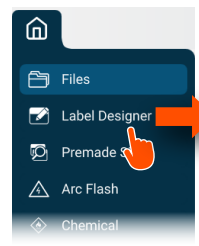

1. Open Label Designer

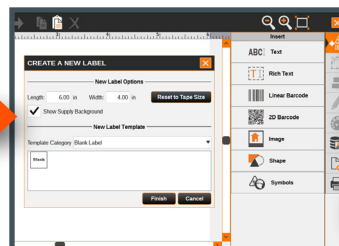

2. Select label size

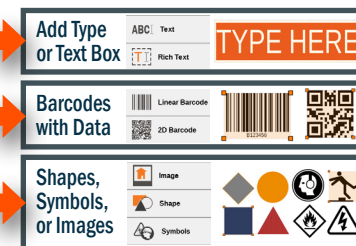

3. Customize your label



4. Click print